



Your Swiss Experience





Welcome to the SwissTech Convention Center. The venue where virtually everything - physically and digitally - is possible.

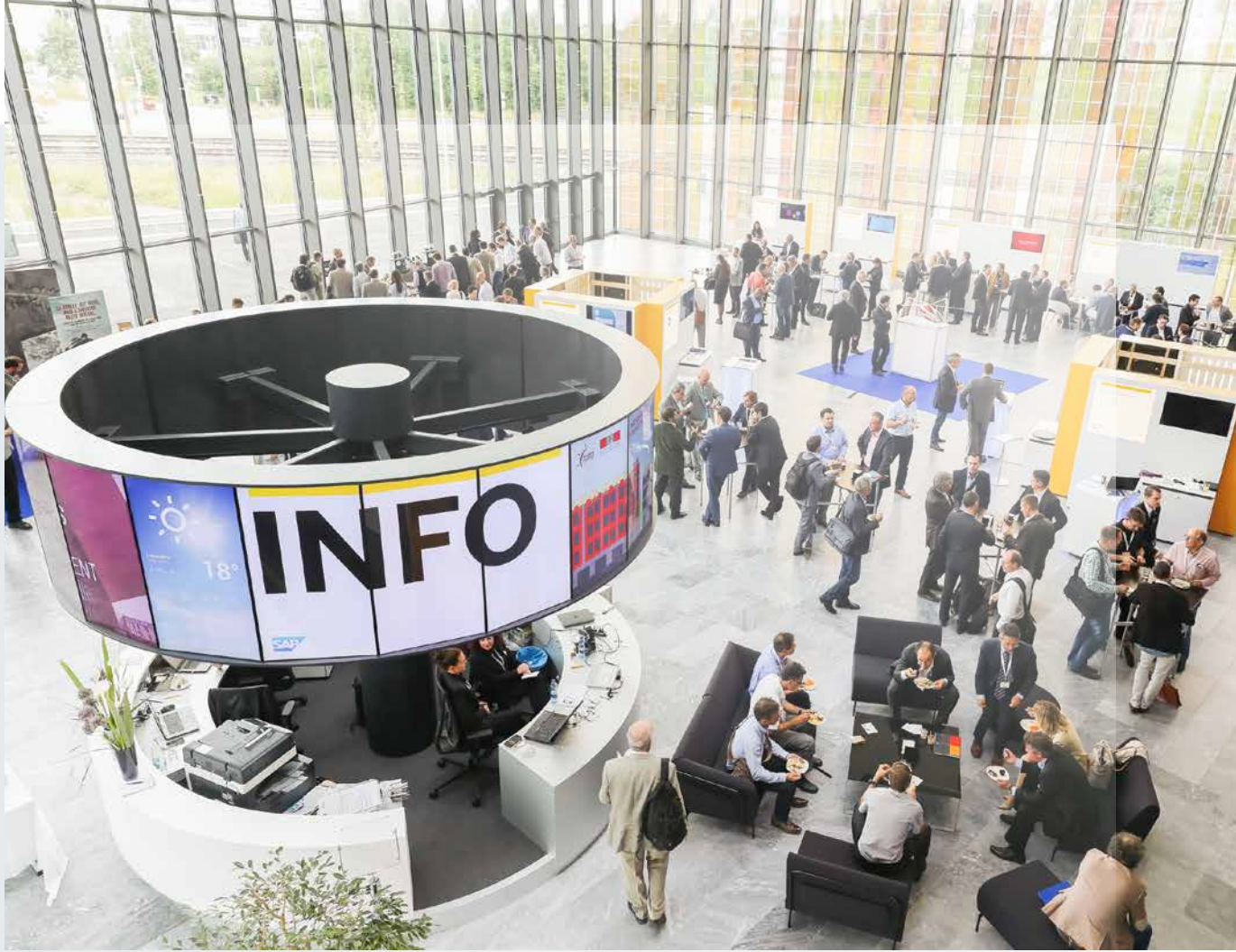

Our Assets

The assets that make the SwissTech Convention Center unique go beyond the benefits of its architecture, location and general facilities as a convention center.

You and your participants will benefit from a sustainable venue, Swiss know-how, the experience and support of a professional team, as well as the pioneering spirit and history of the EPFL.

28 ROOMS

OVER **7,000 M²**
(75,000 FT²)

LARGE AUDITORIUMS
WITH UP TO **3,000** SEATS

BEAUTIFUL VIEW
ON **THE ALPS**
& **GENEVA LAKE**



SWISS MADE

The SwissTech offers the best of Switzerland – from its location within the exceptional natural environment of Lake Geneva, to the outstanding quality and efficiency of Swiss service and know-how.



SUSTAINABILITY

As part of the EPFL, the SwissTech Convention Center is a laboratory in a true sense. The architecture of the SwissTech includes several breakthrough discoveries made at EPFL, like using the water of Lake Geneva to cool the building and making windowpanes act as solar panels. The building was designed to be as energy efficient as possible, using primarily natural light, and 100% of our energy comes from renewable sources.



A TEAM OF EXPERTS

Efficient and adaptable, organized and precise, our team brings years of expertise.

With practical suggestions and assistance, we accompany you throughout the various stages and specificities of your project, converting your dream event into reality.



THE EPFL ENVIRONMENT

For over 50 years, EPFL has established itself as a leading technical university in Europe, with a focus on education, research and innovation. It contributes to progress and positive impact on various levels of society.



A University, a Convention Center and a Shared Philosophy

With its solid reputation and a proven track record of success, EPFL provides a dynamic and thriving environment for its 4000 researchers to develop cutting-edge projects that have a significant, sustainable and innovative impact on society, health and the environment.

They focus on drone technology, cancer treatment biotechnologies, global transport and mobility solutions, neuroprosthetic and robotic systems, among many others.

**OVER 120
DIFFERENT
NATIONALITIES**

ARE REPRESENTED
IN ITS CLASSROOMS,
LABORATORIES AND
OFFICES, MAKING IT
ONE OF THE MOST
INTERNATIONAL
TECHNICAL
UNIVERSITIES IN
EUROPE.



EPFL SCHOOLS & COLLEGES:

- School of Architecture, Civil and Environmental Engineering
- School of Computer and Communication Sciences
- School of Basic Sciences
- School of Engineering
- School of Life Sciences
- College of Humanities
- College of Management of Technology

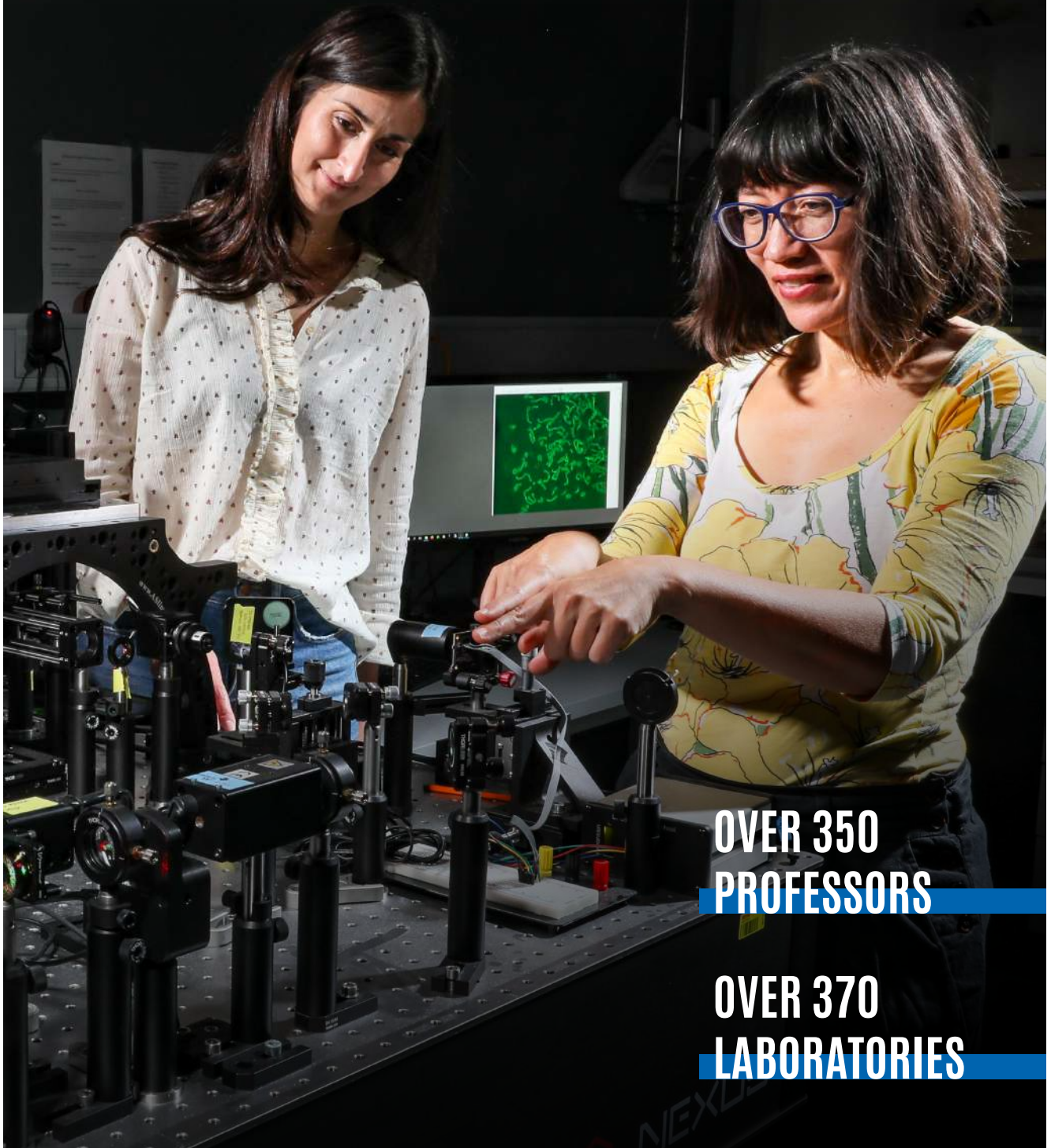

**OVER 350
PROFESSORS**

**OVER 370
LABORATORIES**

Lausanne & Switzerland

At the very heart of Europe, literally

We are located in Lausanne, in the French speaking area of Switzerland, in the beautiful natural environment of Lake Geneva and the Swiss Alps.



LAUSANNE: DOLCE VITA, SWISS-STYLE

Named the best small town in the world in the first "Small Cities Index", Lausanne combines the benefits of a large urban center with the relaxed pace of a small town.

Lausanne is a friendly and cosmopolitan place, home to the International Olympic Committee and sport federations headquarters. Prestigious schools such as the International Institute for Management Development (IMD) and Ecole Hôtelière de Lausanne (EHL) are also located in the city.

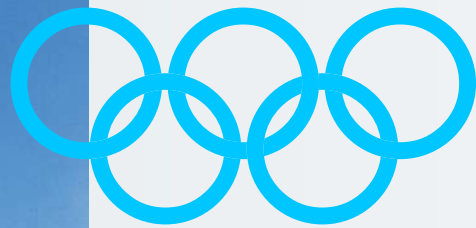

A FAVORITE CULTURAL HALLMARK IS THE OLYMPIC MUSEUM AND LAUSANNE IS HOME TO THE INTERNATIONAL OLYMPIC COMMITTEE AND HAILED AS THE OLYMPIC CAPITAL OF THE WORLD.

Stretched along Lake Geneva and with 350 hectares of parks and gardens, Lausanne is easy to navigate with public transportation, it is the smallest city in the world to have a metro.

Shopping lovers will find the best Swiss products to bring home, from fashion to food and technology,

especially in the Flon, a neighborhood of successfully rehabilitated warehouses, the commercial and social beating heart of the city.

Active, creative, colorful, Lausanne has a decisive, delightful Latin vibe.



THE NEIGHBORING LAVAUX REGION IS
A UNESCO WORLD HERITAGE SITE

SIDE EVENTS

From wine-tasting to culture, hiking and sightseeing, the Lausanne region offers the perfect place to relax and discover.

Wherever You Are Lausanne is Easy to Reach

No matter where you, or where your participants are based, reaching Lausanne and the SwissTech Convention Center is easy and convenient.

One of the city's biggest assets is its highly strategic position in Europe: Lausanne is at the center of the efficient European train network.

It is also located between two busy and well-connected international airports, Geneva and Zurich.

On a micro level, public transportation - convenient, quick and reliable - is the easiest way to move around Lausanne: the M1 metro brings you right in front of the SwissTech Convention Center, a short commute from the city center.





**LAUSANNE
TRAIN STATION**

- GENEVA - 0:37
- ZURICH - 2:08
- LYON - 2:40
- MILAN - 3:22
- PARIS - 3:41
- FRANKFURT - 5:26
- BRUSSELS - 6:21



GENEVA / ZURICH

- PARIS - 1:00
- BRUSSELS - 1:15
- BARCELONA - 1:25
- LONDON - 1:30
- PRAGUE - 1:30
- VIENNA - 1:35
- BERLIN - 1:40
- MADRID - 1:50



THE LAUSANNE TRANSPORT CARD, OFFERED TO ALL HOTEL GUESTS, PROVIDES FREE ACCESS TO PUBLIC TRANSPORT AS WELL AS DISCOUNTS AND FREE ADMISSIONS WITH SELECT PARTNERS.



AUDIOVISUAL



CATERING



EXHIBITION



EVENT
MANAGEMENT

Swiss-made Services



WE **COSTUMIZE** THE SPACE TO YOUR NEEDS: 28 FULLY MODULAR ROOMS - 3 LARGE AUDITORIUMS AND 25 BREAK-OUT ROOMS - CAN BE TRANSFORMED WITHIN MINUTES THANKS TO GALA® AND SKYFOLD® TECHNOLOGIES.

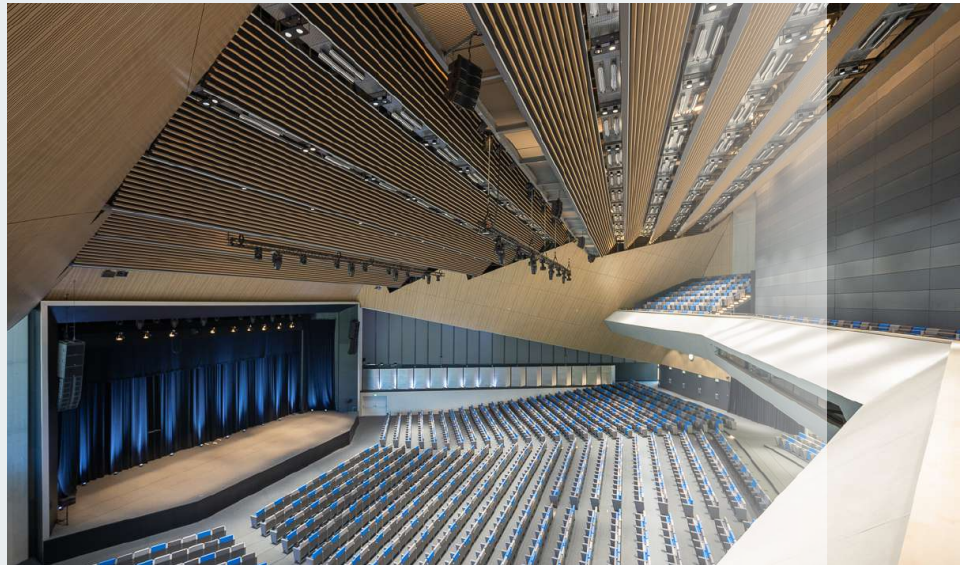

WE **DELIGHT** THE AUDIENCE WITH STATE-OF-THE-ART AUDIOVISUAL EXPERTISE AND EQUIPMENT.





WE **CONNECT** PARTICIPANTS, WHETHER IN THE ROOM OR REMOTE, IN HYBRID OR FULLY VIRTUAL MODES.



WE **ACCOMPANY** YOU IN THE SELECTION AND BRIEFING OF PREMIUM PARTNERS.



WE **FOCUS** ON DETAILS AND MAKE SURE YOU LEVERAGE ALL OUR INFRASTRUCTURE: OUR BUSINESS CENTER; VIP LOUNGE; TECHNICAL AND INTERPRETERS' BOOTHS AND INFIRMARY.



The SwissTech Village



Located right in front of the Convention Center, the SwissTech Village offers a 65-room hotel - an ideal solution to accommodate your

keynote speakers and staff - as well as restaurants, bars, supermarkets, a pharmacy, a medical center and a hairdresser.



Your Event: 100 Ideas, 1000 Solutions



We work hand in hand with our clients to select the best configuration to deliver on the events objectives and ensure a memorable experience for the audience.

Modular by design and adaptable by spirit, the SwissTech Convention Center can host any kind of event you choose to host:

- Hybrid & Virtual
- Congresses & Exhibitions
- Galas & Celebrations
- Conferences & Meetings
- Seminars & Workshops



LIVE STREAM



AREA OF
A ROOM



STANDING
CAPACITY



SEATING
CAPACITY



INTERACTIVITY



DAYLIGHT



TABLE
CAPACITY



LIVE STREAM



INTERACTIVITY

Hybrid & Virtual: Our Auditorium D

Our auditorium D builds on the latest technologies to ensure a seamless event. Our in-house team is always ready to help.

Do you want to split your audience –one part in attendance at the SwissTech Convention Center, and another attending digitally? Or you need a last-minute change, and host everyone online? The solution is Auditorium D.

We have implemented solutions for the creation of digitized events, in hybrid or virtual format, while maintaining your objectives and the typical program and features of an on-site event.



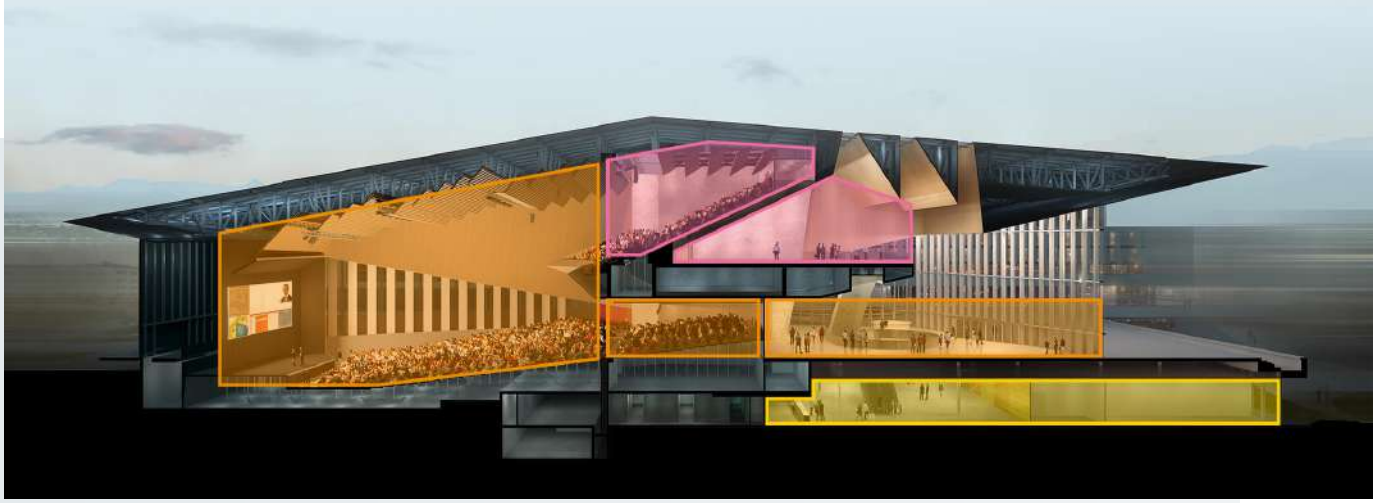

4800 M²



3000



DAYLIGHT

Congresses & Exhibitions

Technology allows us to adapt the size of our main auditoriums with various modular spaces. In other words, the set-up is custom-made to match the audience size, never feeling too empty nor too cramped.



THANKS TO THE SWISSTECH AND THE FANTASTIC LOCATION, THIS YEAR'S CONFERENCE WAS A GREAT SUCCESS."

Associate Director
ESACT Meeting



3500 M²



3300



MAX 1200



DAYLIGHT

Galas & Celebrations

The SwissTech is a wonderful venue to organize celebrations and given that the spaces can be transformed within minutes, it is possible to change configurations - theater seating, standing, dining - as many times as required within the same event.



Whether you are organizing a banquet for thousands of attendants, or just a small gathering, the different spaces can be set up ideally and accordingly: the space of our modular auditoriums can be totally transformed, in only 15 minutes.

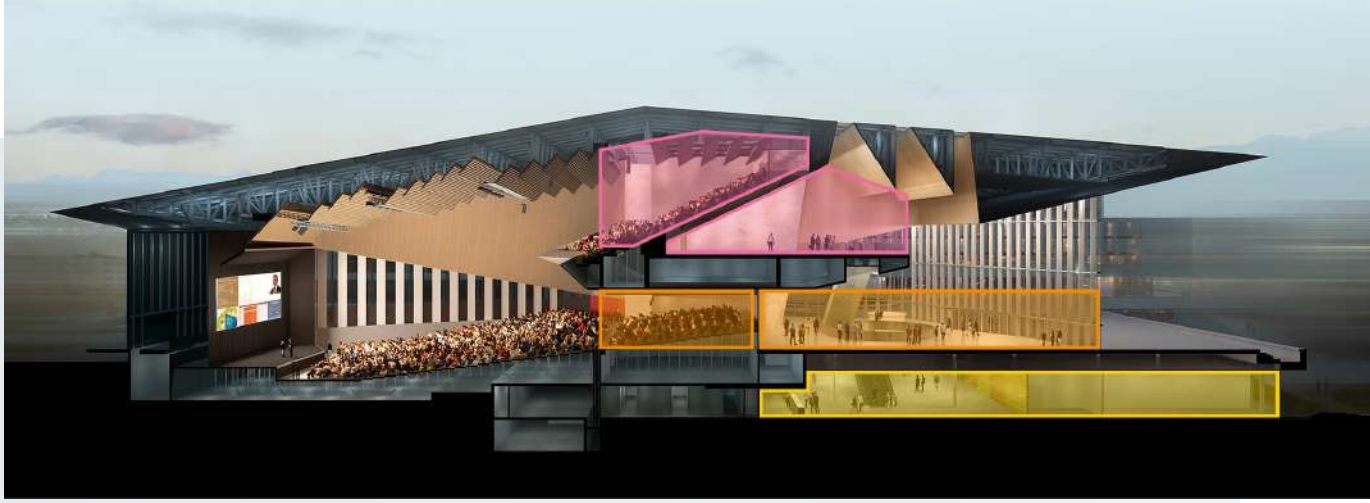

2300 M²



3000



DAYLIGHT

Conferences & Meetings

Our 28 rooms and flexible infrastructure enable us to adapt to the size of the audience



“WE ARE ABLE TO ORGANIZE A HIGH EVENT IN A BEAUTIFUL PLACE. FROM THE WELCOME COFFEE, THROUGH THE TECHNIQUE TO THE COCKTAIL, GUESTS ENJOYED THE EVENT.”

CEO & Founder - Planitswiss
General Assembly Logitech

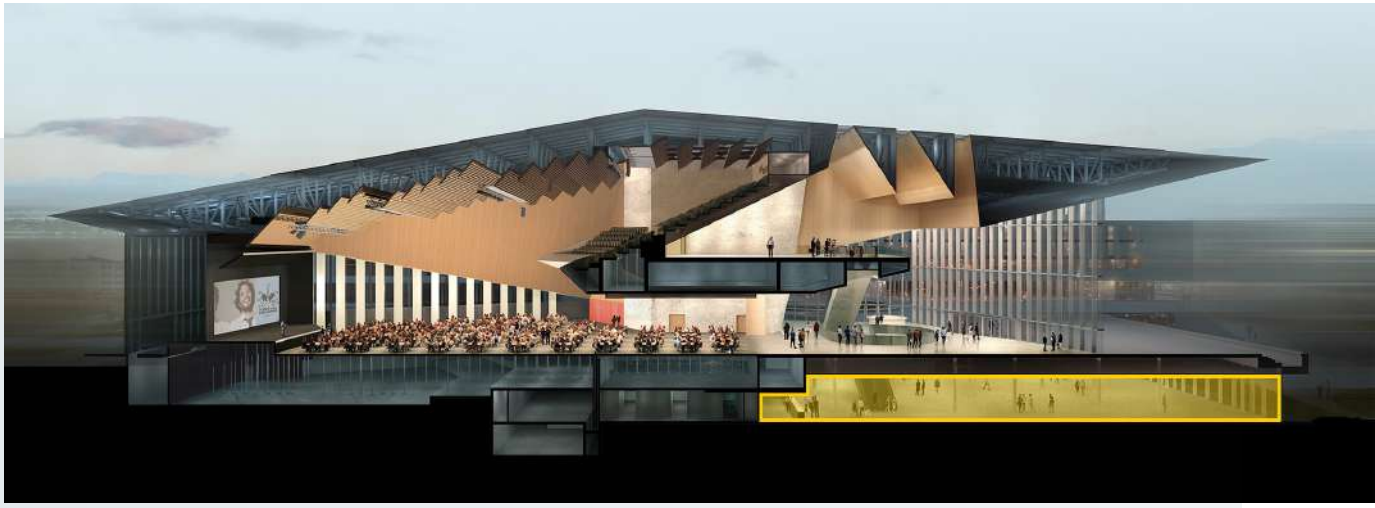

1000 M²



MAX 2500



MAX 500

Seminars & Workshops

Dedicated spaces for brainstorming sessions and smaller workshops.



A sliding-wall system at the Garden level allows a total modularity of the space, making it possible to divide the space into 17 independent rooms, from 30 to 330 places.



Swiss Know-How at Your Service



SWISSTECH
CONVENTION CENTER

1015 Lausanne
+41 21 693 42 42
welcome@stcc.ch
stcc.ch